



Carrwood Hey

Bury, BL0 9QT

Offers over £375,000



This stylish 4-bedroom semi-detached family home in Ramsbottom offers its lucky new owners beautifully decorated interiors and a great selection of well-proportioned rooms. A contemporary, country aesthetic runs throughout the interior décor, giving the property notable charm and character. Your beautiful new home is ready to simply move in, unpack and enjoy – perfect for family life.



A Brief Overview

Situated close to amenities and schools, with 4 bedrooms, 2 bathrooms, 2 lounges, a dining room, kitchen, utility, and guest WC, plus a double tandem driveway and gardens to front and rear, this property has lots to offer!!

Step Inside

Your front door is privately tucked away in the corner of your integral car port, and behind it lies the entrance hall connecting your downstairs living spaces...

A chimney breast holds the centre of your principal sitting room, home to a feature fireplace filled with candles to bring about a cosy glow, and contemporary light-grey panelling creates your first glimpse of that country character and charm. The small trees and bushes bordering your front garden create privacy and a real cosy feel in this room; a room that is perfect for time with the family, and catching up on your favourite Netflix shows snuggled up in front of the TV.

Next to your principal sitting room is your second lounge, which benefits from glass sliding doors onto your back garden, allowing an abundance of natural light to pour in and create a lovely bright and airy space. Imagine the doors open onto your decking on warm summer days, bringing the outside in. And if your kids are always fighting over whose watching what on TV, or whose turn it is on the Xbox or Playstation, this room provides a handy space for an extra TV!

As well as practicalities for the kids and family life, this immaculate home also benefits from a space excellent for entertaining – your kitchen and dining room...

Like the second lounge, your kitchen is bright and airy thanks to the light, neutral colour scheme, and the French doors onto your back garden allowing natural light to pour in and bounce off the tiled flooring. White tiled splashbacks complement the wooden worktops, perfectly in keeping with the country style décor and stainless-steel handles stand out boldly on the beige cupboards bringing a touch of contrast. This kitchen is fitted with a Neff, four plate hob and extractor, and electric oven.

Through the kitchen into your dining room and the beautiful panelling continues, with brilliant white looking superb against the dark blue above. This space would be great for a dinner party! And a guest WC is conveniently located off this space too, which further sits next to your utility and laundry room. More handy storage space can be found under the stairs.

Beds & Baths

Upstairs the beautiful décor continues. Your upstairs briefly consists of a generous master bedroom with en-suite, 3 other bedrooms, a main family bathroom, and substantial loft.

Your master bedroom comes complete with an en-suite and plenty of floorspace – spanning the entire length of the property's extension – which provides ample room for all your needs. The current homeowners have used a section of the room as a handy home workspace with computer and desk. Maybe that would benefit you too? Or there's enough space for a walk-in wardrobe if that's your cup of tea! Your four-piece en-suite features a walk-in shower, wash basin, loo, and bidet – presented beautifully in excellent condition with tiled flooring and walls. And your three other bedrooms follow suit in their presentation and condition – two of which are doubles and one of them a single.

The main family bathroom is fitted out as a wet room and benefits from a four-piece suite including a large bath with jets, wash basin, loo, and shower*, Tan coloured tiles line the walls and give this room a cosy ambience – perfect for a relaxing candle lit bath making use of those jets!

*Shower requires installation of tray or amending the gradient of floor to ensure proper drainage.

Outside Space

This home comes with a fabulous family garden... With plenty of decking creating a great amount of space for al-fresco dining and enjoying summer days with family and friends, and a lawn at the bottom of the garden for the kids to play, this garden is fab for the whole family. In addition, a garden like this will be easy to maintain all year round.

A Highly Convenient Spot!

Central Ramsbottom is only a leisurely stroll or short drive away, providing plentiful amenities; and nearby transport links provide easy access into Bury, Manchester and beyond. With a great variety of amenities and good schools in walking distance, this generous semi-detached home is in a highly convenient spot!

These particulars, whilst believed to be accurate are set out as a general outline only for guidance and do not constitute any part of an offer or contract. Intending purchasers should not rely on them as statements of representation of fact, but must satisfy themselves by inspection or otherwise as to their accuracy. No person in this firm's employment has the authority to make or give any representation or warranty in respect of the property.

Claves.

Claves House, 295D Darwen Road, Bromley Cross, BL7 9BT.
t. 01204 929 940 | e. info@claves.co.uk | w. claves.co.uk

Area Map



Floor Plans

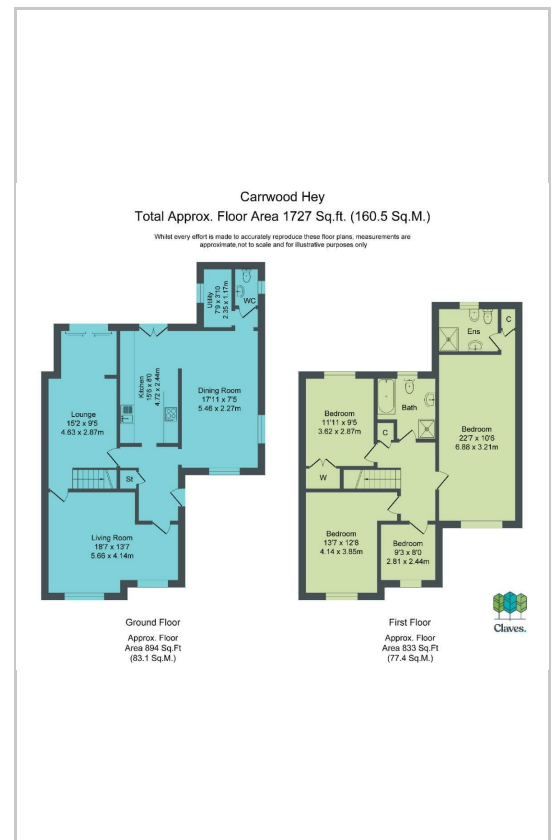

Energy Efficiency Graph

